

Clover Go All-in-One — version 2

MAI code = AA129H / Part # =MIS-RP457BT-FDC

Equipment Description: FD ClvrGo NFC RDR V2

Fast

Can process EMV transactions in under 3.5 seconds

Compact

Dimensions: H: 2.5 x W: 2.6 x D: 0.9 in.

Weight: 2.67 oz.

Comprehensive

Accepts swipe, insert, and tap transactions on one device*

Flexible

Pairs with your iOS or Android phone or tablet via Bluetooth

Powerful

Estimated 160 insert/EMV, 160 swipe, or 130 contactless transactions per charge**

Secure

Tamper responsive - if someone tries to break open the device, it automatically stops working.



Existing



Front



Back

Re-Designed



Front



Back

*Clover Go does not support chip & PIN transactions. The device must be charged in order to take payments.
**Numbers may vary depending on the combination of transactions per charge

Clover Go All-in-One: Cable-less Stand

MAI Code = AA12AN / Part# = STCK-457BT-DOCK

Equipment Description: ClvrGo Dock V2

- No visible cable to plug RP450
- Place the RP450 by sliding the reader laterally into the stand
- Screw hole allowing to lock RP450
- Battery LED visible
- Screw holes to enable a fixed mounted position
- Option to lock reader into stand with provided screw lock
- Silicone pad, similar to current stand, for easy moving of the stand

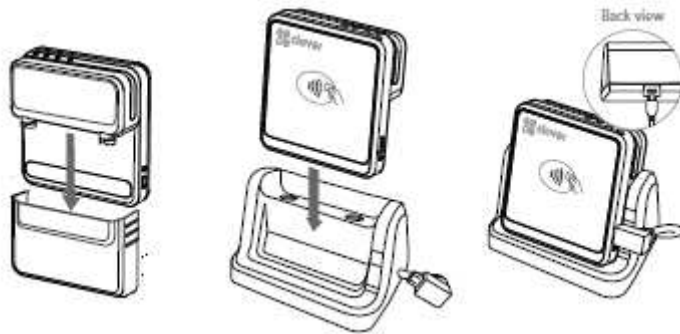

Existing Reader and Stand



Re-designed Reader and Stand

All-In-One Contactless Card Reader Belt Clip & Lanyard (lanyard not pictured) Fits both the v1 and v2 versions of the All-in-One Contactless Card Reader

MAI Code = AA12AQ / Part # = MIS-RP457BT-CLP
Equipment Description: Universal Clip (RP457C/BT)

